

Yuba Community College District

No. RFP 22-14

New Softball Field

ADDENDUM NO. 2

Thursday, July 13, 2023

District: Yuba Community College District
3301 E Onstott Rd
Yuba City, CA 95991
Contact: David Willis, Dir. of Maintenance, Operations, and Planning

Job Location: Yuba Community College
2088 N Beale Rd
Marysville, CA 95901

Architect: Hibser Yamauchi Architects, Inc.
4602 2nd St
Davis, CA 95618

This Addendum has been prepared to clarify, modify, delete, or add to the drawings and/or specifications for the above referenced project, and revisions to items listed here shall supersede description thereof prior to the above stated date. All conditions not specifically referenced here shall remain the same. It is the obligation of the Prime Contractor to make subcontractors aware of any items herein that may affect submitted bids. Acknowledge receipt of this addendum by inserting its number and date in the bidding documents. Failure to do so may subject bidder to disqualification. All addenda items refer to the plans and specifications unless specifically noted otherwise.

PART A – GENERAL

N/A

PART B – BIDDING AND CONTRACT REQUIREMENTS

2.1 Section 00 11 13 – Advertisement for Bids – Proposal Due Date

- A. **REVISE** proposal due date to July 20, 2023: 12:00pm noon.
- B. **CLARIFICATION.** Signed hard copy of proposal, including all other required documents, shall be provided to District at address listed by time above sharp. An electronic PDF copy shall be provided within 24 hours of bids due. Any electronic proposals received prior to the due date/time will be referenced and read aloud during bid open.

Yuba Community College District

No. RFP 22-14

New Softball Field

ADDENDUM NO. 2

2.2 Section 01 50 00 – Temporary Facilities & Controls – Staging and Lay-Down

- A. **CLARIFICATION.** District will allow staging and lay-down for construction purposes in parking area west of and/or in field south of new field location. Contractor shall be responsible for securing equipment and materials for project and shall provide temporary fencing around project site.

PART C – CHANGES TO TECHNICAL SPECIFICATIONS

2.3 Section 11 68 33.33 – Softball Field Equipment

- A. **ADD** Section 11 68 33.33 in its entirety for dugout accessories. **See attached ‘Section 11 68 33.33 – Softball Field Equipment’**

2.4 Section 11 68 43 – Exterior Scoreboards

- A. **ADD** Section 11 68 43 in its entirety for exterior scoreboards. **See attached ‘Section 11 68 43 – Exterior Scoreboards’**

2.5 Section 12 93 00 – Site Furnishings

- A. **ADD** Section 12 93 00 in its entirety for exterior bike racks. **See attached ‘Section 12 93 00 – Site Furnishings’**

PART D – CHANGES TO DRAWINGS:

2.6 Refer to Drawing Sheet C3.1

- A. **REVISE** area outside of right field (and between new walkway) to planting area in lieu of decomposed granite. **See attached ‘Sheet C3.1’**

2.7 Refer to Drawing Sheet C3.2

- A. **REVISE** area outside of right field (and between new walkway) to planting area in lieu of decomposed granite. **See attached ‘Sheet C3.2’**

2.8 Refer to Drawing Sheet C5.1

- A. **REVISE** area outside of right field (and between new walkway) to planting area in lieu of decomposed granite. **See attached ‘Sheet C5.1’**

2.9 Refer to Drawing Sheet L1.1

Yuba Community College District

No. RFP 22-14

New Softball Field

ADDENDUM NO. 2

- A. **REVISE** area north of northern bullpen to decomposed granite in lieu of planting and omit irrigation in area. **See attached 'Sheet L1.1'**

2.10 Refer to Drawing Sheet L2.1

- A. **REVISE** area north of northern bullpen to decomposed granite in lieu of planting and omit irrigation in area. **See attached 'Sheet L2.1'**

PART E – RFIs

- 2.11 Question:** Is a builder's risk policy required?

Response: Yes.

- 2.12 Question:** Is an installation floater policy required?

Response: *Contractor shall carry floater policy if builder's risk policy does not provide adequate coverage for work. The District shall not be held responsible for any damage or loss of construction equipment and/or materials as a result of theft, vandalism, or mishandling.*

- 2.13 Question:** Can the schedule of values be submitted within 24 hours after the bid opening?

Response: Yes.

- 2.14 Question:** Confirm bleachers are OFCI. Provide specifications and section detail for the bleachers.

Response: *Bleachers shall be Owner-furnished / Owner-installed. Bidder/Contractor shall coordinate and provide foundations per Manufacturer drawings provided in Addendum No.1. Refer to 'FOUNDATION NOTES' on sheet B3.*

- 2.15 Question:** Confirm the score board and video display are OFCI. Provide score board & video display specifications

Response: *Bidder/Contractor shall provide and install new scoreboard. Video display was omitted from scope per Addendum No.1. Refer to PART C of this addendum for scoreboard specifications (Section 11 68 43).*

- 2.16 Question:** Provide dugout bench specifications

Yuba Community College District

No. RFP 22-14

New Softball Field

ADDENDUM NO. 2

Response: Refer to PART C of this addendum for bench specifications (Section 11 68 33.33).

2.17 Question: Provide bat rack specifications.

Response: Refer to PART C of this addendum for bench specifications (Section 11 68 33.33).

2.18 Question: Provide wall shelf specifications.

Response: Refer to PART C of this addendum for bench specifications (Section 11 68 33.33).

2.19 Question: Provide specifications for secure bike locker.

Response: Provide bike racks as indicated per plans. Refer to PART C of this addendum for bike rack specifications (Section 12 93 00).

2.20 Question: Provide section B-B as noted. Provide fastener specifications.

Response: Section B-B is the cross section of the post and board attachment shown in the upper right hand corner of the detail. It was not labeled B-B, but this was the intent.

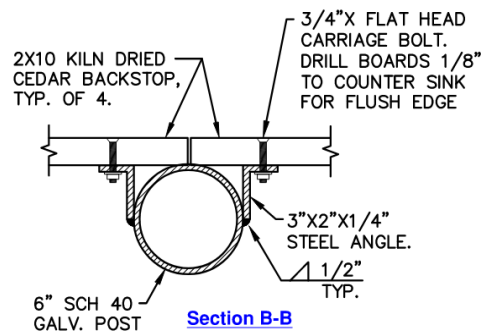

2.21 Question: We have assumed that (5) 2x10 are required. Provide confirmation.

Response: Correct, 5X10'S would be required to get the total height shown, not 4 as indicated in the detail.

Yuba Community College District

No. RFP 22-14

New Softball Field

ADDENDUM NO. 2

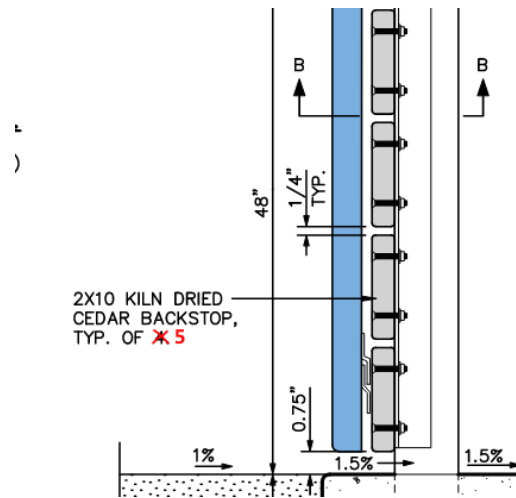

2.22 Question: Is the 40' container a part of the project? If so, provide specifications.

Response: *No. Provide container pad as indicated per plans.*

2.23 Question: Provide water fountain specifications.

Response: *Note 22.03 states "SCD" or see civil drawings. Civil plan C4.2 shows this and detail 1, 2 and 4 on C7.6 detail the fountain and give type and model.*

2.24 Question: ADA urinal is 17 1/4" from floor to front lip – California ADA Code is 17" – Is it necessary to lower urinal 1/4"? I have seen inspectors require 17" max.

Response: *Relocate urinal such that rim does not exceed 17".*

2.25 Question: Data Component List on sheet E1.02 under Cat 6 Ethernet patch cables states "other Cat 6 cables as required for other equipment (cameras, PA system, etc). There are no cameras or PA system shown on the drawings. Is this camera system and PA system in this scope?

Response: *There are no cameras or PA systems in this project.*

2.26 Question: What are the data requirements at the WAP at the dugout? One (1) Cat 6 or two (2).

Response: *(1) Cat6.*

Yuba Community College District

No. RFP 22-14

New Softball Field

ADDENDUM NO. 2

2.27 Question: What is the pathway and data requirements for the scoreboard?

Response: *Scoreboard communications is via wireless network. Refer to PART C in this addendum for scoreboard specifications.*

List of Attachments

- Section 11 68 33.33 – Baseball Field Equipment (3 pages, 8½ x 11)
- Section 11 68 43 – Exterior Scoreboards (5 pages, 8½ x 11)
- Section 12 93 00 – Site Furnishings (5 pages, 8½ x 11)
- Sheet C3.1 (30 x 42 dwg)
- Sheet C3.2 (30 x 42 dwg)
- Sheet C5.1 (30 x 42 dwg)
- Sheet L1.1 (30 x 42 dwg)
- Sheet L2.1 (30 x 42 dwg)

End of Addendum No.2

SECTION 11 68 33.33
Baseball Field Equipment

PART 1 - GENERAL

1.1 SECTION INCLUDES

- A. Miscellaneous athletic equipment – Dugout bench, bat rack, shelving.

1.2 RELATED SECTIONS

- A. Section 11 68 33 – Athletic Field Equipment

1.3 SUBMITTALS

- A. Submit under provisions of Section 01 33 00.
- B. Shop Drawings: Show list of materials and equipment, sizes of all members, method of construction and operation, installation details, and all other pertinent information. Include structural calculations by engineer registered in California.
- C. Product Data: Manufacturer's catalog for each item specified, with model number listed, showing mounting, adjustment, and operation of the equipment.

1.4 QUALITY ASSURANCE

- A. Material and equipment shall be furnished by manufacturers regularly engaged in production of these items.
- B. Manufacturer's recommendations shall be followed in all cases for installation and conditions.
- C. Comply with all applicable codes and regulations.

1.5 PROJECT CONDITIONS

- A. Examine the substrates and supporting structure and the conditions under which the Work is to be installed, and notify the Architect in writing of conditions detrimental to the Work. Do not proceed with the installation until unsatisfactory conditions have been corrected.

1.6 COORDINATION

- A. Cooperate with various other trades in coordinating their Work required in conjunction with Work under this Section.

- B. Before fabrication, verify all measurements at jobsite to ensure proper fit. Verify exact location of structural framing members required to support backboard, and install in accordance with approved Shop Drawings.

1.7 WARRANTY

- A. Procedures: In accordance with Section 01 78 36
- B. Manufacturer's Warranties:
 - 1. Provide one (1) manufacturer's standard warranty.

PART 2 - PRODUCTS

2.1 MANUFACTURERS

- A. Acceptable Manufacturers: PYT Sports, <http://pytsports.net>; or approved equal.
- B. Unless otherwise indicated, products and catalog numbers specified are by PYT Sports and are listed for convenience in establishing required equipment and are listed for appearance, quality, and utility identification only. The listing is not intended to limit selection of similar products from other manufacturers complying with the requirements of the Contract Documents and submitted for approval in accordance with the General Conditions and Section 01 62 00.
- C. Unless modified by these Specifications or notations on the Drawings, catalog description for indicated number shall constitute the basic requirements for each item. Equipment shall incorporate all features set forth in the catalogue for the specified item except for modifications specified herein.

2.2 ATHLETIC EQUIPMENT

- A. Benches: PYT Sports Model No. "Eagle Bench"; or approved equal.
 - 1. Size: Refer to drawings.
 - 2. Finish: Exterior-grade acrylic paint.
 - a. Color: TBD; as selected by Architect from Manufacturer's full range of colors.
 - b. Logo: TBD; at each end of bench.
- B. Bat Rack: PYT Sports Model No. "Angled Bat Rack"; or approved equal.
 - 1. Size: Refer to drawings.

2. Finish: Exterior-grade acrylic paint.
 - a. Color: TBD; as selected by Architect from Manufacturer's full range of colors.
 - b. Logo: TBD; at face of unit.
- C. Shelf: PYT Sports Model No. "Player Shelf"; or approved equal.
 1. Size: Refer to drawings.
 2. Finish: Exterior-grade acrylic paint.
 - a. Color: TBD; as selected by Architect from Manufacturer's full range of colors.
 3. Accessories:
 - a. Double-hooks.

PART 3 - EXECUTION

3.1 EXAMINATION

- A. Substrates to receive materials specified under this Section shall be carefully examined before beginning Work. Defects shall be reported to the Architect in writing. Work shall not be started until such defects have been corrected. Starting Work shall imply acceptance of conditions as they exist.
- B. Verify field measurements. Report any discrepancies between the Drawing dimensions and field dimensions which will affect the installation to the Architect.

3.2 INSTALLATION

- A. Install equipment in accordance with manufacturer's recommendations. Coordinate installation with other trades to assure proper connections and function.
- B. Clean and test all movable equipment to assure smooth operation. Adjust as required.

END OF SECTION

SECTION 11 68 43

Exterior Scoreboards

PART 1 - GENERAL

1.1 SECTION INCLUDES

- A. Single-sided LED baseball scoreboard

1.2 REFERENCES

- A. Standard for Electric Signs, UL 48
- B. Standard for CSA C22.2 #207
- C. Federal Communications Commission Regulation Part 15
- D. National Electric Code

1.3 SUBMITTALS

- A. Product data: Submit manufacturer's product illustrations, data and literature that fully describe the scoreboards and accessories proposed for installation.
- B. Shop drawings: Submit mechanical and electrical drawings.
- C. Maintenance data: Submit manufacturer's installation, operation, and maintenance manuals.

1.4 DELIVERY, STORAGE, AND HANDLING

- A. Product delivered on site
- B. Scoreboard and equipment to be housed in a clean, dry environment

1.5 PROJECT CONDITIONS

- A. Environmental limitations: Do not install scoreboard equipment until mounting structure is secure and concrete has ample time to cure.
- B. Field measurements: Verify position and elevation of structure and its layout for scoreboard equipment. Verify dimensions by field measurements.
- C. Verify mounting structure is capable of supporting the scoreboard's weight and windload in addition to the auxiliary equipment.

- D. Installation may proceed within acceptable weather conditions.

1.6 QUALITY ASSURANCE

- A. For outdoor use
- B. Source Limitations: Obtain each type of scoring or related equipment through one source from a single manufacturer.
- C. ETL listed to UL 48
- D. NEC compliant
- E. FCC compliant
- F. ETL listed to CSA 22.2 #207

1.7 WARRANTY

- A. Provide 5 years of no cost parts exchange including standard shipping on electronics parts and radios due to manufacturing defects

PART 2 - PRODUCTS

2.1 MANUFACTURER

- A. Daktronics, Inc., 201 Daktronics Drive, P.O. Box 5128, Brookings, SD 57006-5128
- B. Or approved equal.

2.2 PRODUCT

- A. Basis-of-Design: Daktronics BA-2014 single-sided baseball scoreboard displays HOME and GUEST team scores for up to eight innings, total RUNS and HITS to 99 and ERR (errors) to nine for each team, BALL to three, STRIKE to two and OUT to two, and H/E (hit or error).

2.3 SCOREBOARD

- A. General information
 - 1. Dimensions: 6'-6" (1.98 m) high, 20'-0" (6.10 m) wide, 0'-8" (203 mm) deep
 - 2. Base weight: 600 lb (272 kg) with vinyl captions – options may increase

weight

3. Base power requirement: 275 W (red/amber digits), 600 W (white digits) with vinyl captions – options may increase wattage
4. Color: provide over 150 colors to choose from

B. Construction

1. Alcoa aluminum alloy 5052 for excellent corrosion resistance
2. Scoreboard back, face, and perimeter: 0.063" (1.60 mm) thick
3. Scoreboard top and bottom: 0.125" (3.18 mm) thick

C. Digits

1. LED color:

D. BALL, STRIKE, OUT and RUNS digits Red

1. BALL, STRIKE, OUT, and H/E digits: 18" (457 mm) high
2. Inning scores, RUNS, HITS, and ERR digits: 15" (381 mm) high
3. Seven bar segments per digit
4. PanaView® LED digit technology
5. All digits are sealed front and back with weather-tight silicone gel

E. Captions

1. Vinyl applied directly to scoreboard face; TIME on changeable caption panel
2. HOME and GUEST captions: 12" (305 mm) high
3. BALL, STRIKE, OUT, and H/E captions: 10" (254 mm) high
4. Inning numbers, RUNS, HITS, and ERR captions: 8" (203 mm) high
5. Color: standard white or others available upon request

F. Accessory Equipment

1. [Vinyl striping applied around the scoreboard face]
2. [Programmable Team Name Message Centers (TNMCs) – add 80 lb (36 kg) and 270 W]

2.4 SCORING CONSOLE

- A. Console is an All Sport® 5000 controller
- B. Scores multiple sports using changeable keyboard inserts
- C. Controls multiple scoreboards and displays, including other All Sport 5000 controlled displays currently owned by customer
- D. Recalls clock, score, and period information if power is lost
- E. Runs Time of Day and Segment Timer modes
- F. Console includes:
 - 1. Rugged aluminum enclosure to house electronics
 - 2. Sealed membrane water-resistant keyboard
 - 3. 32-character LCD to verify entries and recall information currently displayed
 - 4. Power cord that plugs into a standard grounded outlet; 6 watts max
 - 5. Control cable to connect to the control receptacle junction box (wired system only)
 - 6. Hand-held switch for main clock start/stop and horn
 - 7. Soft-sided carrying case
- G. Accessory Equipment
 - 1. 2.4 GHz spread spectrum radio system with frequency hopping technology and 64 non-interfering channels; system includes a transmitter installed inside the console and a receiver installed inside the scoreboard(s)

PART 3 - EXECUTION

3.1 EXAMINATION

- A. Verify that mounting structure is ready to receive scoreboard. Verify that placement of conduit and junction boxes are as specified and indicated in plans and shop drawings. Verify concrete has cured adequately according to specifications.

3.2 INSTALLATION

- A. All power and control cables to scoreboards and displays will be routed in

conduit. Power to the scoreboards/displays as well as raceways shown on electrical plans by the Electrical Contractor. Scoreboard control wiring including conduit will be the responsibility of the contractor assigned the scoreboard equipment.

- B. Install scoreboards and exterior displays to beams in location detailed and in accordance with manufacturer's instructions. Verify unit is plumb and level.

3.3 INSTALLATION—CONTROL CENTER

- A. Provide boxes, cover plates and jacks in locations per plans.
- B. Test connect control unit to all jacks and check for proper operation of control unit, scoreboard and all features. Leave control unit in carrying case and other loose accessories with owner's designated representative.
- C. Verify earth ground does not exceed 15 ohms.

END OF SECTION

SECTION 12 93 00 Site Furnishings

PART 1 - GENERAL

1.1 SECTION INCLUDES

- A. Bike racks.

1.2 REFERENCES

- A. The publications listed below form a part of this Specification to the extent referenced. The publications are referred to in the text by basic designation only.
- B. American Society for Testing and Materials (ASTM):
 - 1. ASTM A135 (21) – Standard Specification for Electric-Resistance-Welded Steel Pipe.
 - 2. ASTM A153 (16a) – Standard Specification for Zinc Coatings (Hot-Dip) on Iron and Steel Hardware.
 - 3. ASTM A385 (20) – Standard Practice for Providing High-Quality Zinc Coatings (Hot-Dip).
 - 4. ASTM A500 (21) – Standard Specification for Cold-Formed Welded and Seamless Carbon Steel Structural Tubing in Rounds and Shapes.
 - 5. ASTM A513 (20a) – Standard Specification for Electric-Resistance-Welded Carbon and Alloy Steel Mechanical Tubing.
 - 6. ASTM B221 (20) – Standard Specification for Aluminum and Aluminum-Alloy Extruded Bars, Rods, Wire, Profiles, and Tubes.
 - 7. ASTM B241 (16) – Standard Specification for Aluminum and Aluminum-
Allow Seamless Pipe and Seamless Extruded Tube.

1.3 PERFORMANCE REQUIREMENTS

- A. Installer Qualifications: Engage an experienced installer or applicator that has specialized for a minimum of 5 years in installing the specific site furnishings required for this Project and who is acceptable to manufacturer of primary materials.
- B. Assign a full-time employee to the job as supervisor for the duration of the Contract with a minimum of four years experience in site furnishing installation.

- C. Labor Force: Provide installation and maintenance force thoroughly familiar with, and trained in, the Work to be accomplished to perform the task in a competent, efficient manner, acceptable to the District..

1.4 REGULATORY REQUIREMENTS

- A. Conform to all Federal, State, [District,] and local codes and requirements for installation and disabled accessibility as referenced herein and as applicable.

1.5 SUBMITTALS

- A. Submit under provisions of Section 01 33 00.
- B. Should it be necessary to propose equipment other than that specified, submit complete manufacturer's information, including catalog cuts, installation procedures and diagrams, maintenance instructions, etc. Provide three copies.
- C. Manufacturer information: "Installation Guide and Owner's Manual - U/2 Racks".
- D. Maintenance Data: Included in Owner's Manual
- E. Samples for Verification: Cross Sections of finished rack.

1.6 QUALITY ASSURANCE

- A. Manufacturer: Company specializing in the manufacture of products specified in the Section with a minimum of five years documented experience.
- B. Installer: Company specializing in applying the Work of the Section with minimum three years documented experience, approved by manufacturer.

1.7 WARRANTY

- A. Provide one (1) year warranty under provisions of Section 01 77 00.
- B. Warranty shall include coverage for discoloration of surfaces due to cleaning, crazing, cracking, and staining.

1.8 DELIVERY, STORAGE AND HANDLING

- A. Equipment shall be delivered and stored in accordance with the manufacturer's recommendations.

PART 2 - PRODUCTS

2.1 GENERAL

- A. Products specified are indicative of the features, form, finish, and quality of the furnishings desired. Products of manufacturers other than those named may be acceptable upon proof of equality. Submit data as specified above.
- B. All products shall be new, delivered to the site in manufacturer's original containers, and protected at all times from damage during shipping, storage, and handling prior to and during installation.

2.2 ACCEPTABLE MANUFACTURERS

- A. Bike Racks:
 - 1. Cycle-Safe; <http://cyclesafe.com>. 1-888-950-6531.
 - 2. Or approved equal.
 - 3. Basis-of-Design: CycleSafe U/2 Rack
 - a. U/2 Round: 1.90" OD Stainless Steel Pipe
 - b. Material: 1.5" ASTM A53 Type F Schedule 40 Black Pipe or ASTM A312 Schedule 40 Type 304 Stainless Steel Pipe.
 - c. Construction: Rolled 180 degree 10.1 inch IR bend x 35-3/4 inches high.
 - d. Mounts: Surface, Ground and Rail mountings
 - e. Surface Mounting is accomplished with 3/8 inch x 2-1/2 inch x 6-1/2 inch welded base plates.
 - f. Ground Mounting is accomplished by extending the pipe legs by 12 inches for 47-3/4 inch height and seep holes at bottom of legs.
 - g. Rail Mounting is accomplished with two (2) C3 x 4.1# structural steel punched channels.
 - h. Finish: Satin #4.

PART 3 - EXECUTION

3.1 GENERAL

- A. Installation of products shall be as shown on the Drawings, or according to manufacturer's instructions. If discrepancies are found, or if information is

lacking, consult with Architect immediately, prior to beginning the Work.

3.2 INSPECTION

- A. Verify that all units are as specified and are delivered free of charge.
- B. Verify that all accessories required for installation are provided.

3.3 COORDINATION

- A. In-ground installation of picnic tables and benches with installation of paving and decomposed granite and other materials.

3.4 INSTALLATION

- A. Where installation on concrete is specified, install racks on minimum 4 inch thick concrete slabs, sloped to provide drainage (maximum 2 degrees). For other improved surfaces, such as pavers or asphalt, contact the Manufacturer for alternate installation procedures.
- B. In-Ground Mount:
 - 1. Determine desired placement of all bike racks before drilling any holes, avoiding concrete expansion joints. (Recommended spacing is 36-inch centers). Using the predetermined center lines mark (4) hole locations.
 - 2. Existing concrete surface may be core drilled with a 3 inch or 4 inch hole saw and filled with Quikcrete or a construction adhesive.
 - 3. If installing on existing concrete, CycleSafe® U/2 Bike Racks can also be anchored with a non-shrink grout poured into a 4 inch or 6 inch diameter by 12 inch deep core drilled holes.
 - 4. New improved concrete surfaces 9 inch Sonotube forms can be put in place to create 18 inch footings. This is the standard for new construction and the most secure type for inverted U-Racks.

3.5 CLEANING

- A. Clean all installed items, fasteners and supports in accordance with manufacturer's instructions.
- B. Cover or wrap all installed items to protect from weather and dirt from other trades.
- C. Remove protective cover at date of Substantial Completion.

3.6 PROTECTION OF INSTALLED EQUIPMENT

- A. Protect equipment from damage at all times, until final acceptance of the Work. If damage occurs to any equipment prior to final acceptance, Contractor shall, at his own expense, make replacement to satisfaction of the District.

END OF SECTION

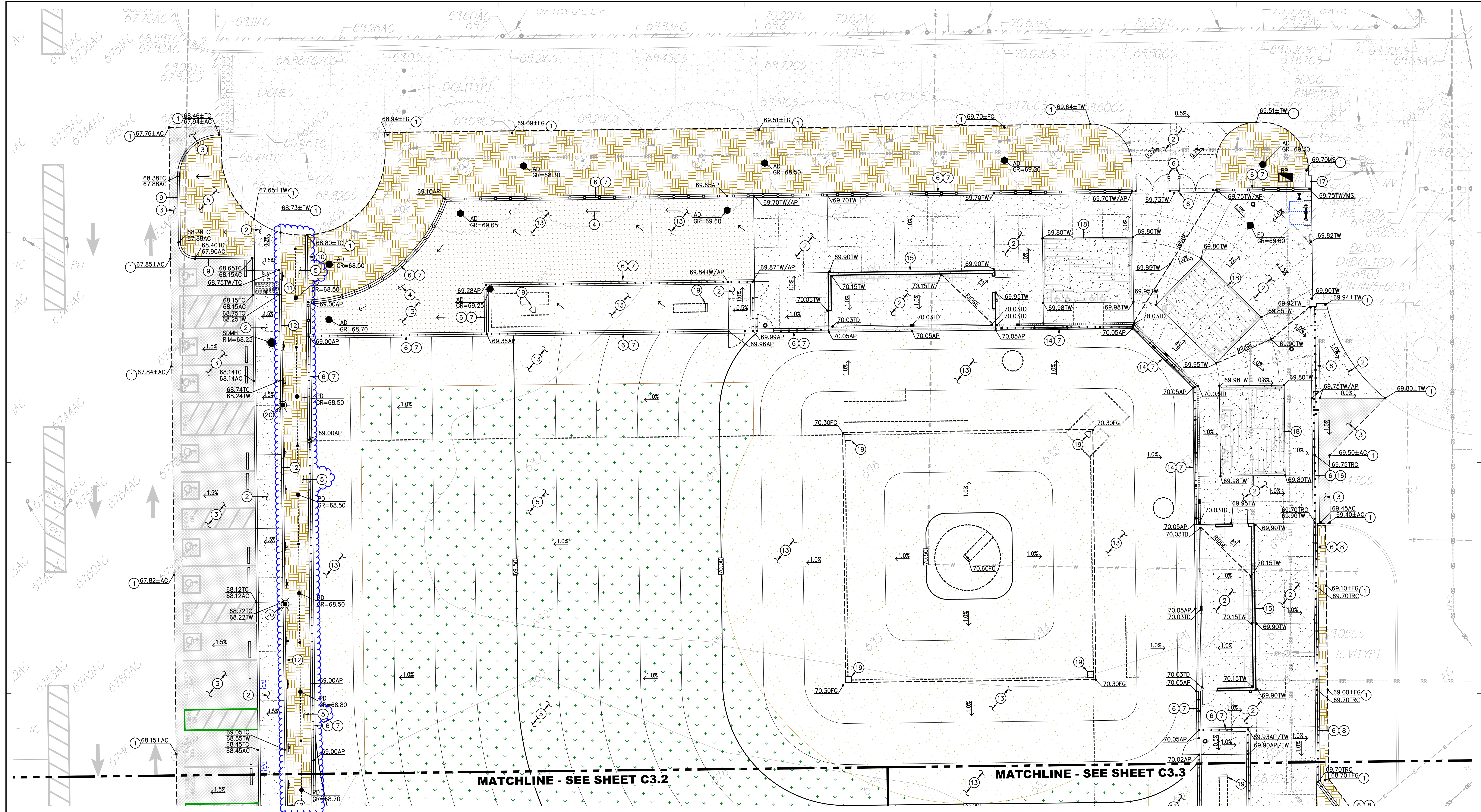

1 GRADING PLAN

SCALE 1" = 10'-0"

CONSTRUCTION NOTES

- MATCH EXISTING GRADE/ELEVATION. WHEN MATCHING NEW SLABS TO EXISTING, PROVIDED DOWELS AT 24" O.C. PER THE DETAIL.
- PLACE NEW REINFORCED CONCRETE PAVING. REFER TO PAVING PLAN FOR SECTIONS. REFER TO DETAILS PROVIDED FOR TYPICAL CONDITIONS. SEE PAVEMENT SLOPE REQUIREMENTS, THIS SHEET.
- PLACE ASPHALT PAVING. REFER TO PAVING PLAN FOR SECTIONS AND SPECIFICATIONS. SEE PAVEMENT SLOPE REQUIREMENTS, THIS SHEET.
- GRADE UNIFORM SWALE AS SHOWN. SIDE SLOPES SHALL NOT EXCEED 1H:3V. RUNNING SLOPE SHALL BE NO LESS THAN 0.5%. IT IS CONTRACTORS RESPONSIBILITY TO ENSURE THAT LANDSCAPE SUBCONTRACTORS DO NOT ALTER GRADED SWALES WITH PLANTING OR OTHER SURFACING.
- PROVIDE NEW LANDSCAPING OR REPAIR OF EXISTING AS DESIGNATED ON PAVING PLAN AND LANDSCAPING PLANS.
- REFER TO FENCING PLAN FOR NEW FENCING AND GATES.
- CONSTRUCT 12" WIDE CONCRETE FENCE APRON PER THE DETAIL PROVIDED.
- CONSTRUCT RAISED 12" WIDE CONCRETE FENCE APRON PER THE DETAIL PROVIDED.
- CONSTRUCT CONCRETE CURB PER THE DETAIL PROVIDED.
- CONSTRUCT 6" WIDE CONCRETE FLUSH CURB PER THE DETAIL PROVIDED.
- CONSTRUCT CONCRETE CURB RAMP WITH TRUNCATED DOMES PER THE DETAIL PROVIDED.
- CONSTRUCT CONCRETE CURB AT BACK OF WALK PER THE DETAIL PROVIDED.

- SEE PAVING PLAN FOR INFIELD MIX, DG AND OTHER AGGREGATE SURFACING.
- SEE FENCING PLAN FOR BACKSTOP.
- SEE ARCH PLANS FOR DUGGOUT CONSTRUCTION.
- CONSTRUCT RAISED CONCRETE FENCE APRON FOR ROLLING GATE PER THE DETAIL PROVIDED.
- CONSTRUCT 18" WIDE CONCRETE APRON AT BUILDING EDGE PER THE DETAIL PROVIDED.
- SEE ARCH. PLANS FOR MODULAR BLEACHER SYSTEM, TO INCLUDE REINFORCED CONCRETE SUPPORT SLABS.
- SEE EQUIPMENT PLANS FOR BASES AND OTHER GAME ACCESSORIES.
- RE-INSTALL LIGHT POLE IN NEW CURB PER THE DETAIL PROVIDED. SEE ELECTRICAL PLAN FOR CONDUIT AND CONNECTIONS.

PAVEMENT SLOPES
 ALL PAVING SURFACES SHALL BE CONSTRUCTED IN ACCORDANCE WITH THE GENERAL PAVING SURFACE NOTES ON C0.1. CLARIFIED AS FOLLOWS:
 • CONCRETE FLATWORK, ALL - PER GENERAL PAVING SURFACE NOTES ON C0.1
 • ASPHALT PAVING, CROSSWALK - PER GENERAL PAVING SURFACE NOTES ON C0.1
 • ASPHALT PAVING, ACCESSIBLE PARKING & LOADING - 1.8% MAX ANY DIRECTION.
 • ASPHALT PAVING, ACCESSIBLE LOADING VEHICLE SPACE - 1.8% MAX ANY DIRECTION.
 • ASPHALT PAVING, NORMAL PARKING SPACES - 4.0% MAX ANY DIRECTION.
 • ASPHALT PAVING, PARKING DRIVE ISLES - 4.0% MAX ANY DIRECTION.
 • ASPHALT PAVING, PARKING ENTRANCE AND EXIT - 4.0% CROSS, 7.0% RUNNING.
 CONSTRUCTION TOLERANCES HAVE BEEN FACTORED INTO THE DESIGN, HOWEVER, CONTRACTOR SHALL FIELD CHECK FORMS AS THEY ARE CONSTRUCTED, WHEN THEY ARE COMPLETE, AND ALSO PRIOR TO POURING.

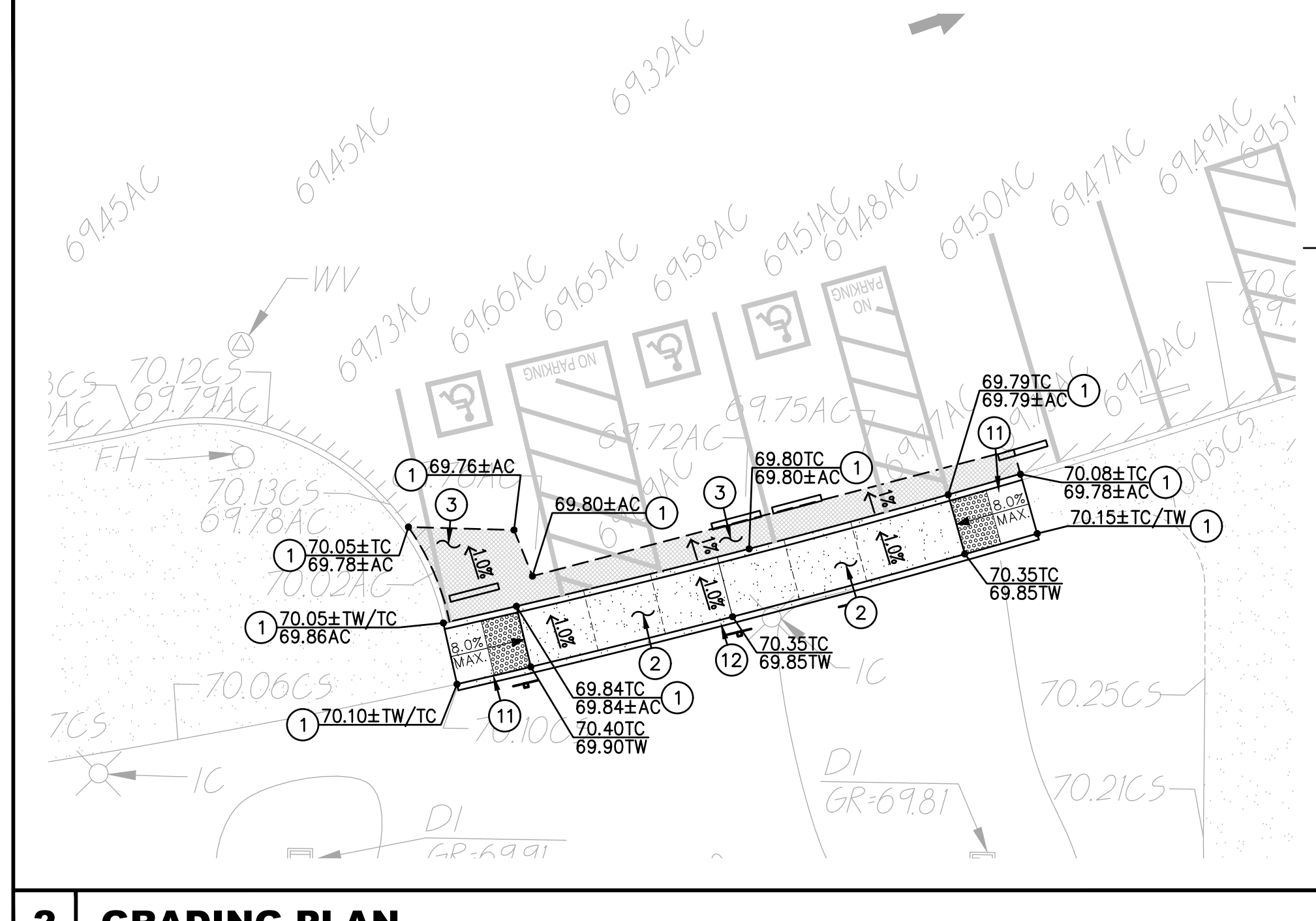
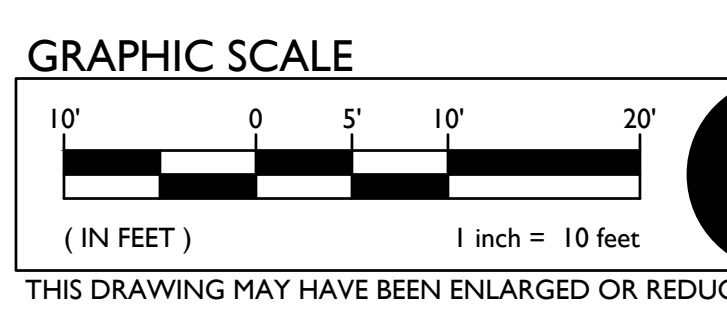

2 GRADING PLAN

SCALE 1" = 10'-0"



Revisions	Delta	Date	Revisions	By

DSA BACKCHECK



This document is the property of the Owner and is not to be used without his written permission.



YUBA COMMUNITY COLLEGE
 2088 NORTH BEALE ROAD
 MARYSVILLE, CA 95901

Project: **SOFTBALL FIELD**

Sheet Title: **GRADING PLAN**

Client Project Number:	Client Proj:
Scale:	Sheet
Drawn By: Author	C3.1
Checked By: Checker	
Issue Date: Issue Date	
Revit Version: 2023	

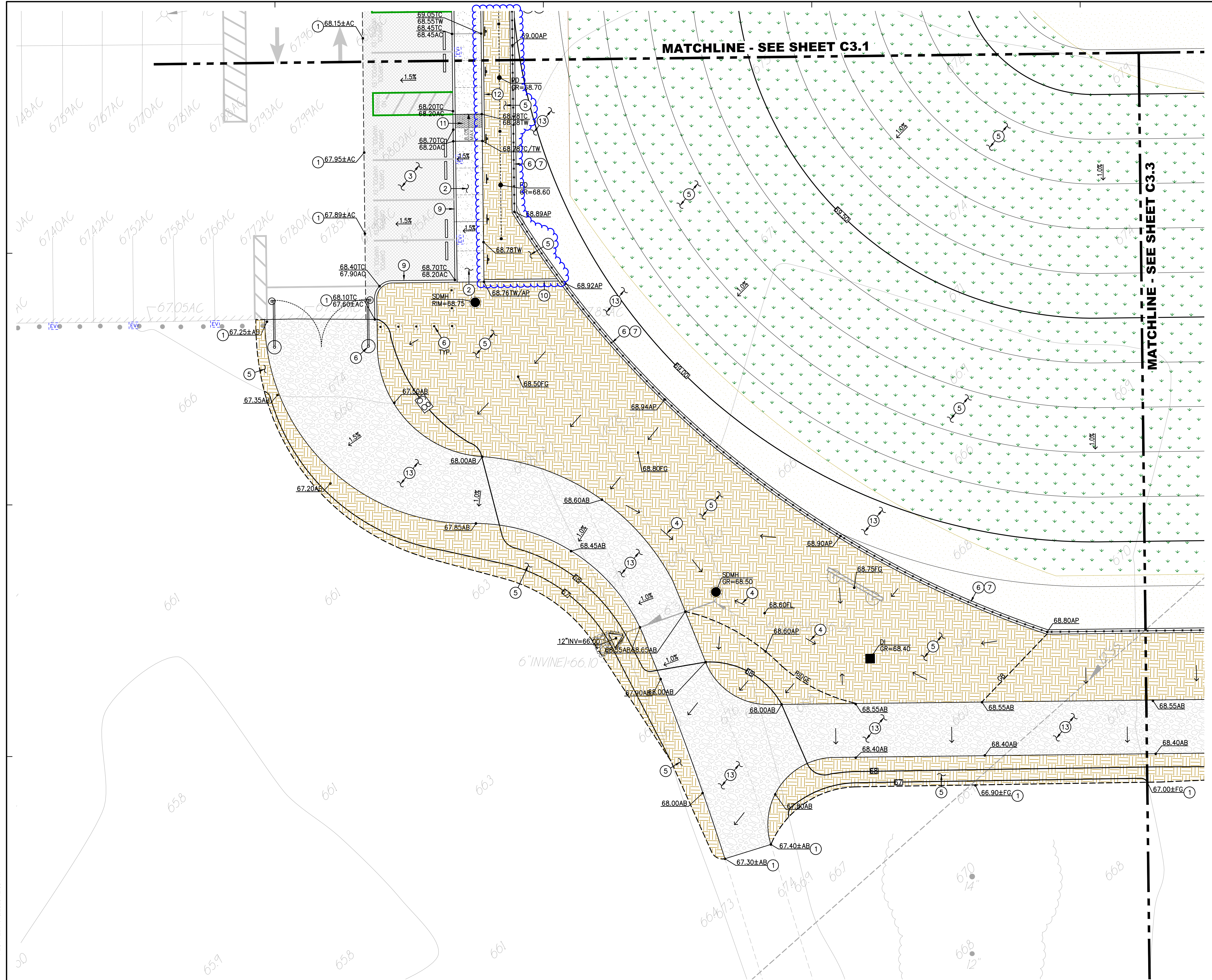

PAVEMENT SLOPES
 ALL PAVING SURFACES SHALL BE CONSTRUCTED IN ACCORDANCE WITH THE GENERAL PAVING SURFACE NOTES ON C0.1, CLARIFIED AS FOLLOWS:
 • CONCRETE FLATWORK, ALL - PER GENERAL PAVING SURFACE NOTES ON C0.1
 • ASPHALT PAVING, CROSSWALK - PER GENERAL PAVING SURFACE NOTES ON C0.1
 • ASPHALT PAVING, ACCESSIBLE PARKING & LOADING - 1.8% MAX ANY DIRECTION.
 • ASPHALT PAVING, ACCESSIBLE LOADING VEHICLE SPACE - 1.8% MAX ANY DIRECTION.
 • ASPHALT PAVING, NORMAL PARKING SPACES - 4.0% MAX ANY DIRECTION.
 • ASPHALT PAVING, PARKING DRIVE ISLES - 4.0% MAX ANY DIRECTION.
 • ASPHALT PAVING, PARKING ENTRANCE AND EXIT - 4.0% CROSS, 7.0% RUNNING.
 CONSTRUCTION TOLERANCES HAVE BEEN FACTORED INTO THE DESIGN, HOWEVER, CONTRACTOR SHALL FIELD CHECK FORMS AS THEY ARE CONSTRUCTED, WHEN THEY ARE COMPLETE, AND ALSO PRIOR TO POURING.

CONSTRUCTION NOTES

- MATCH EXISTING GRADE/ELEVATION, WHEN MATCHING NEW SLABS TO EXISTING, PROVIDED DOWELS AT 24" O.C. PER THE DETAIL. 9
C7.1
- PLACE NEW REINFORCED CONCRETE PAVING, REFER TO PAVING PLAN FOR SECTIONS. REFER TO DETAILS PROVIDED FOR TYPICAL CONDITIONS. SEE PAVEMENT SLOPE REQUIREMENTS, THIS SHEET. 1
C7.1 2
C7.1 9
C7.1
- PLACE ASPHALT PAVING, REFER TO PAVING PLAN FOR SECTIONS AND SPECIFICATIONS. SEE PAVEMENT SLOPE REQUIREMENTS, THIS SHEET.
- GRADE UNIFORM SWALE AS SHOWN. SIDE SLOPES SHALL NOT EXCEED 1H:3V. RUNNING SLOPE SHALL BE NO LESS THAN 0.5%. IT IS CONTRACTORS RESPONSIBILITY TO ENSURE THAT LANDSCAPE SUBCONTRACTORS DO NOT ALTER GRADED SWALES WITH PLANTING OR OTHER SURFACING.
- PROVIDE NEW LANDSCAPING OR REPAIR OF EXISTING AS DESIGNATED ON PAVING PLAN AND LANDSCAPING PLANS.
- REFER TO FENCING PLAN FOR NEW FENCING AND GATES.
- CONSTRUCT 12" WIDE CONCRETE FENCE APRON PER THE DETAIL PROVIDED. 15
C7.1
- CONSTRUCT RAISED 12" WIDE CONCRETE FENCE APRON PER THE DETAIL PROVIDED. 21
C7.1
- CONSTRUCT CONCRETE CURB PER THE DETAIL PROVIDED. 5
C7.1
- CONSTRUCT 6" WIDE CONCRETE FLUSH CURB PER THE DETAIL PROVIDED. 20
C7.1
- CONSTRUCT CONCRETE CURB RAMP WITH TRUNCATED DOMES PER THE DETAIL PROVIDED. 11
C7.1
- CONSTRUCT CONCRETE CURB AT BACK OF WALK PER THE DETAIL PROVIDED. 3
C7.1
- SEE PAVING PLAN FOR INFIELD MIX, DG AND OTHER AGGREGATE SURFACING.
- SEE FENCING PLAN FOR BACKSTOP.
- SEE ARCH PLANS FOR DUGGOUT CONSTRUCTION.
- CONSTRUCT RAISED CONCRETE FENCE APRON FOR ROLLING GATE PER THE DETAIL PROVIDED. 23
C7.1
- CONSTRUCT 18" WIDE CONCRETE APRON AT BUILDING EDGE PER THE DETAIL PROVIDED. 22
C7.1
- SEE ARCH. PLANS FOR MODULAR BLEACHER SYSTEM, TO INCLUDE REINFORCED CONCRETE SUPPORT SLAB.
- SEE EQUIPMENT PLANS FOR BASES AND OTHER GAME ACCESSORIES.



Revisions	Delta	Date	Revisions	By

DSA BACKCHECK

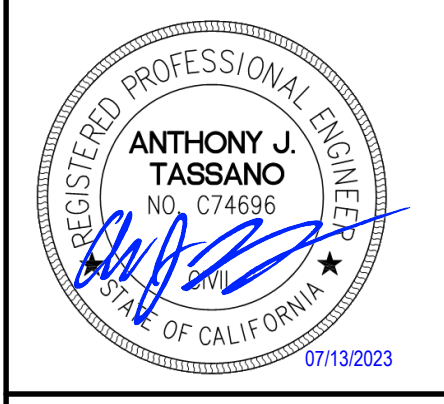

This document is the property of the Owner and is not to be used without his written permission.



HY Architects Project number: 5924
 Facility
 YUBA COMMUNITY COLLEGE
 2088 NORTH BEALE ROAD
 MARYSVILLE, CA 95901

Project
 SOFTBALL FIELD

Sheet Title
 GRADING PLAN

Client Project Number:	Client Proj.
Scale:	Sheet
Drawn By: Author	C3.2
Checked By: Checker	
Issue Date: Issue Date	
Revit Version: 2023	
Sheet	of _____

1 GRADING PLAN

SCALE 1" = 10'-0"

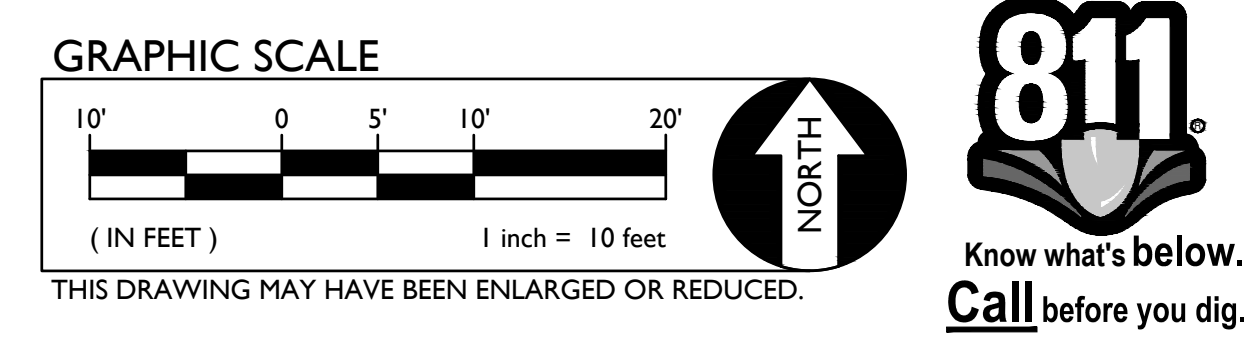

FILE: I:\22-119\CIVIL-SOFTBALL\DWG2-119-C3.1.DWG
 PLOTTED: 7/13/2023 12:05 PM
 SAVED: 7/13/2023 12:05 PM



NON EXPANSIVE FILL ALTERNATIVES

AT CONTRACTORS OPTION AND IN ACCORDANCE WITH SPECIFICATION SECTION 31 00 00 AND 31 32 00, THE FOLLOWING ARE ACCEPTABLE ALTERNATIVES TO IMPORTED NON-EXPANSIVE ENGINEERED FILL IN THE TOP 12" OF SUBGRADES FOR BUILDINGS, FLATWORK AND PAVING:

- 8" OF CLASS II AGGREGATE BASE PLACED IN TWO 4" LIFTS, EACH MOISTURE CONDITIONED AND COMPACTED TO 95% OVER TENSAR B31100 OR TRIAX 140, ON 12" DEEP SCARIFIED AND COMPACTED SUBGRADE PER 31 00 00.
- 12" OF CLASS II AB PLACED IN TWO 6" LIFTS, EACH MOISTURE CONDITIONED AND COMPACTED TO 95% OVER 12" DEEP SCARIFIED AND COMPACTED SUBGRADE PER 31 00 00.
- NATIVE SOIL PROCESSED AND CURED WITH LIME TO A DEPTH OF 12" IN ACCORDANCE WITH SECTION 31 32 00. SCARIFICATION AND RE-COMPACTMENT OF SUBGRADE IS NOT REQUIRED PRIOR TO LIME TREATMENT, UNLESS SUBGRADE IS HIGHER THAN NATIVE GRADE. IF FILL REQUIRED TO ACHIEVE SUBGRADE, SCARIFY AND FILL TO SUBGRADE ELEVATION IN ACCORDANCE WITH 31 00 00 AND THEN LIME TREAT THE TOP 12" IN ACCORDANCE WITH 31 32 00. LIME TREATMENT OVER-BUILDING SHALL BE EXCAVATED OUT OF PLANTING AREAS AND BACKFILLED WITH ENGINEERED FILL AND TOPPED WITH TOPSOIL. LIME TREATED SOIL DOES NOT NEED TO BE EXCAVATED OUT OF AREAS TO RECEIVE INFIELD MIX.

TO THE GREATEST PRACTICAL EXTENT, THE PROCESSING METHOD USED SHALL BE APPLIED UNIFORMLY SO AVOID A PATCHWORK OF EARTHWORK PROCESSES BENEATH PAVED SURFACES.

FIELD LINE MARKING

- CONTRACTOR TO PROVIDE AND INSTALL FULL LINE MARKING OF INFIELD AND OUTFIELD IN ACCORDANCE WITH NCAA SOFTBALL REGULATIONS.
- MARKING SHALL BE CHALKED ON INFIELD AND WARNING TRACKS AND PAINTED ON OUTFIELD LAWN.
- ALL MARKINGS SHALL BE 2" TO 4" WIDE.
- MARKING SHALL INCLUDE:
 - FOUL LINES
 - BASELINES
 - PITCHING CIRCLE
 - PITCHING LANE
 - BATTER AND CATCHERS BOX
 - COACHES BOX (EACH SIDE)
 - RUNNERS LANE LINE
 - ON DECK CIRCLES
- THERE SHALL BE NO LINES FROM 1ST TO SECOND AND SECOND TO 3RD IN ACCORDANCE WITH NCAA FIELD REGULATIONS.

1 PAVING PLAN

SCALE 1" = 20'-0"

PAVING GENERAL NOTES:

- ASPHALT MIX SHALL MEET CALTRANS SPECIFICATIONS FOR TYPE B ASPHALTIC CONCRETE. REFERENCE CALTRANS SPECIFICATION SECTION 39, AND PROJECT SPECIFICATIONS
- AGGREGATE BASE SHALL MEET CALTRANS SPECIFICATIONS FOR CLASS II AGGREGATE BASE. REFERENCE CALTRANS SPECIFICATION SECTION 26, AND PROJECT SPECIFICATIONS
- ALL AGGREGATE BASE SHALL BE MOISTURE CONDITIONED TO, OR SLIGHTLY ABOVE, OPTIMUM MOISTURE CONTENT AND COMPACTED TO 95% RELATIVE COMPACTION.
- RECYCLED ASPHALT PAVING (RAP) MAY BE USED AS CLASS II BASE MATERIAL PROVIDED IT MEETS CALTRANS SPECIFICATIONS FOR CLASS II AB, REFERENCE CALTRANS SPECIFICATION SECTION 26-1.02A. SEE ALSO MATERIALS TESTING NOTE, THIS SHEET.
- PAVEMENT SUBGRADE PREPARATION, I.E. SCARIFICATION, MOISTURE CONDITIONING, LIME TREATMENT (IF USED), AND COMPACTION SHALL BE PERFORMED AFTER THE INSTALLATION OF UNDERGROUND UTILITIES AND TRENCHES BACKFILLED IN ACCORDANCE WITH THESE PLANS.
- ALL AREAS DISTURBED BY GRADING, DEMOLITION, OR CONSTRUCTION ACCESS, WHICH ARE NOT SURFACED BY THIS SET OF PLANS, OR LANDSCAPE PLANS, SHALL BE SEEDED WITH EROSION CONTROL TYPE NON-WATERED SEED MIX. REFER TO EROSION CONTROL SPECIFICATIONS FOR ACCEPTABLE SEED MIXES.
- ALL NEW ASPHALT PAVING SHALL RECEIVE SEALCOAT, 2 COATS, MIN. REFER TO PROJECT SPECIFICATIONS, WITH EXCEPTION TO THE TRACK PAVING. NO SEALCOAT ON THE TRACK PAVING. CONTRACTOR SHALL ALLOW FOR 30 DAYS MIN. OF ASPHALT PAVEMENT CURING PRIOR TO SEALCOAT PLACEMENT. IF CONTRACTORS SCHEDULE DOES NOT PERMIT CURING, CONTRACTOR WILL PROVIDE, AT HIS COST, TEMPORARY STRIPING. TEMPORARY STRIPING SHALL BE REMOVED AFTER CURING PERIOD AND SEALCOAT APPLIED WITH NEW REPLACEMENT STRIPING. CONTRACTOR SHALL COORDINATE THIS WORK WITH THE OWNER/DISTRICT.

CONCRETE FINISH GENERAL NOTES

- REFER TO ARCHITECTURAL PLANS FOR ANY SPECIAL CONCRETE FINISHES SPECIFIED WHICH SHALL OVERRIDE THOSE SPECIFIED BELOW.
- PROVIDE EQUIVALENT OF MEDIUM BROOM FINISH AT SLOPES UP TO 5.99%, TYPICAL.
- PROVIDE EQUIVALENT OF HEAVY BROOM FINISH AT SLOPES 6% AND GREATER.

CONTRACTORS OPTION

- AT CONTRACTORS OPTION:
 - #4 REBAR AT 24" O.C.E.W. = #3 BARS AT 18" O.C.E.W.
 - #4 REBAR AT 18" O.C.E.W. = #3 BARS AT 12" O.C.E.W.

PAVING LEGEND

- 1 TYPE 1 PAVING - FIRE LANES
4" AC OVER 12" CLASS II AB ON 12" NON-EXPANSIVE ENGINEERED FILL OVER 12" DEEP SCARIFIED AND RE-COMPACTED SUBGRADE. ENGINEERED FILL AND SUBGRADE SHALL BE PLACED AND COMPACTED PER SPECIFICATION SECTION 31 00 00, ASPHALT PER SPECIFICATION SECTION 32 12 00, PROVIDE SEALCOAT PER SPECIFICATIONS, 2 COATS.
- 2 TYPE 2 PAVING - GENERAL PAVING
3" AC OVER 8" CLASS II AB ON 12" NON-EXPANSIVE ENGINEERED FILL OVER 12" DEEP SCARIFIED AND RE-COMPACTED SUBGRADE. ENGINEERED FILL AND SUBGRADE SHALL BE PLACED AND COMPACTED PER SPECIFICATION SECTION 31 00 00, ASPHALT PER SPECIFICATION SECTION 32 12 00, PROVIDE SEALCOAT PER SPECIFICATIONS, 2 COATS.
- 3 TYPE 3 PAVING
PLACE 5" PCC, 3,500 PSI MIN., OVER 4" CLASS II AB ON 12" NON-EXPANSIVE ENGINEERED FILL OVER 12" DEEP SCARIFIED AND RE-COMPACTED SUBGRADE. PLACE #4 REBAR AT 24" O.C.E.W. OR AS STATED IN THE PROJECT SPECIFICATIONS, WHICHEVER IS MORE STRINGENT. SUBGRADE SHALL BE PLACED AND COMPACTED PER SPECIFICATION SECTION 31 00 00, CONCRETE PER SECTION 32 16 00. REFER ALSO TO DETAILS PROVIDED.
- 4 TYPE 4 PAVING
PLACE 5" PCC, 4,000 PSI MIN., OVER 6" CLASS II AB ON 12" NON-EXPANSIVE ENGINEERED FILL OVER 12" DEEP SCARIFIED AND RE-COMPACTED SUBGRADE. PLACE #4 BARS AT 18" O.C.E.W. OR AS STATED IN THE PROJECT SPECIFICATIONS, WHICHEVER IS MORE STRINGENT. SUBGRADE SHALL BE PLACED AND COMPACTED PER SPECIFICATION SECTION 31 00 00, CONCRETE PER SECTION 32 16 00. REFER ALSO TO DETAILS PROVIDED.
- 5 TYPE 5 SURFACING
PLACE 6" LAYER COMPACTED INFIELD CINDER/CLAY MIX OVER SCARIFIED AND COMPACTED SUBGRADE. REFER TO SPECIFICATIONS SECTION 31 00 00 FOR SUBGRADE, AND SECTION 32 15 40 FOR CINDER.
SEE FIELD LINE MARKING NOTE THIS SHEET
- 6 TYPE 6 SURFACING
PLACE BACK 10" MIN. LAYER OF NATIVE OR IMPORTED TOPSOIL FOR NEW LANDSCAPING. SEE LANDSCAPING AND IRRIGATION PLANS FOR ADDITIONAL INFO. EXISTING UNDISTURBED TOPSOIL MAY REMAIN IF GRADING WORK LIMITED (LESS THAN 3" CUT OR FILL). SUBGRADE AND TOPSOIL SHALL BE PLACED AND COMPACTED PER SPECIFICATION SECTION 31 00 00.
SEE FIELD LINE MARKING NOTE THIS SHEET
- 7 TYPE 7 SURFACING
FOLLOWING GRADING AND COMPACTION, HYDROSEED NATIVE AREAS FOR EROSION PROTECTION. SEE SECTION 31 25 00.
- 8 TYPE 8 SURFACING
PLACE 6" COMPACTED CLASS II AB ROAD BASE OVER COMPACTED SUBGRADE. SEE SECTION 31 00 00 FOR SUBGRADE PROCESSING.
- 9 TYPE 9 SURFACING
PLACE 6" LAYER COMPACTED STABILIZED DECOMPOSED GRANITE SURFACING OVER COMPACTED SUBGRADE. SEE SECTION 31 00 00 FOR SUBGRADE PROCESSING. SEE SECTION 32 15 40 FOR DECOMPOSED GRANITE.
- 10 TYPE 7 SURFACING
PATCH BACK AND REPAIR EXISTING LANDSCAPING TO MATCH EXISTING. REPAIR IRRIGATION LINES AND HEADS AS NEEDED AND ADJUST FOR PROPER COVERAGE. PROVIDE NEW TOPSOIL AND MULCH TO MATCH, AS APPLIES.
- 11 TYPE 11 PAVING
REINFORCED BLEACHER SUPPORT SLAB PER BLEACHER DRAWINGS. PROVIDE SLAB AND BASE AGGREGATE PER BLEACHER DRAWINGS, PLACED OVER 12" NON-EXPANSIVE ENGINEERED FILL OVER 12" DEEP SCARIFIED AND RE-COMPACTED SUBGRADE. SUBGRADE SHALL BE PLACED AND COMPACTED PER SPECIFICATION SECTION 31 00 00.

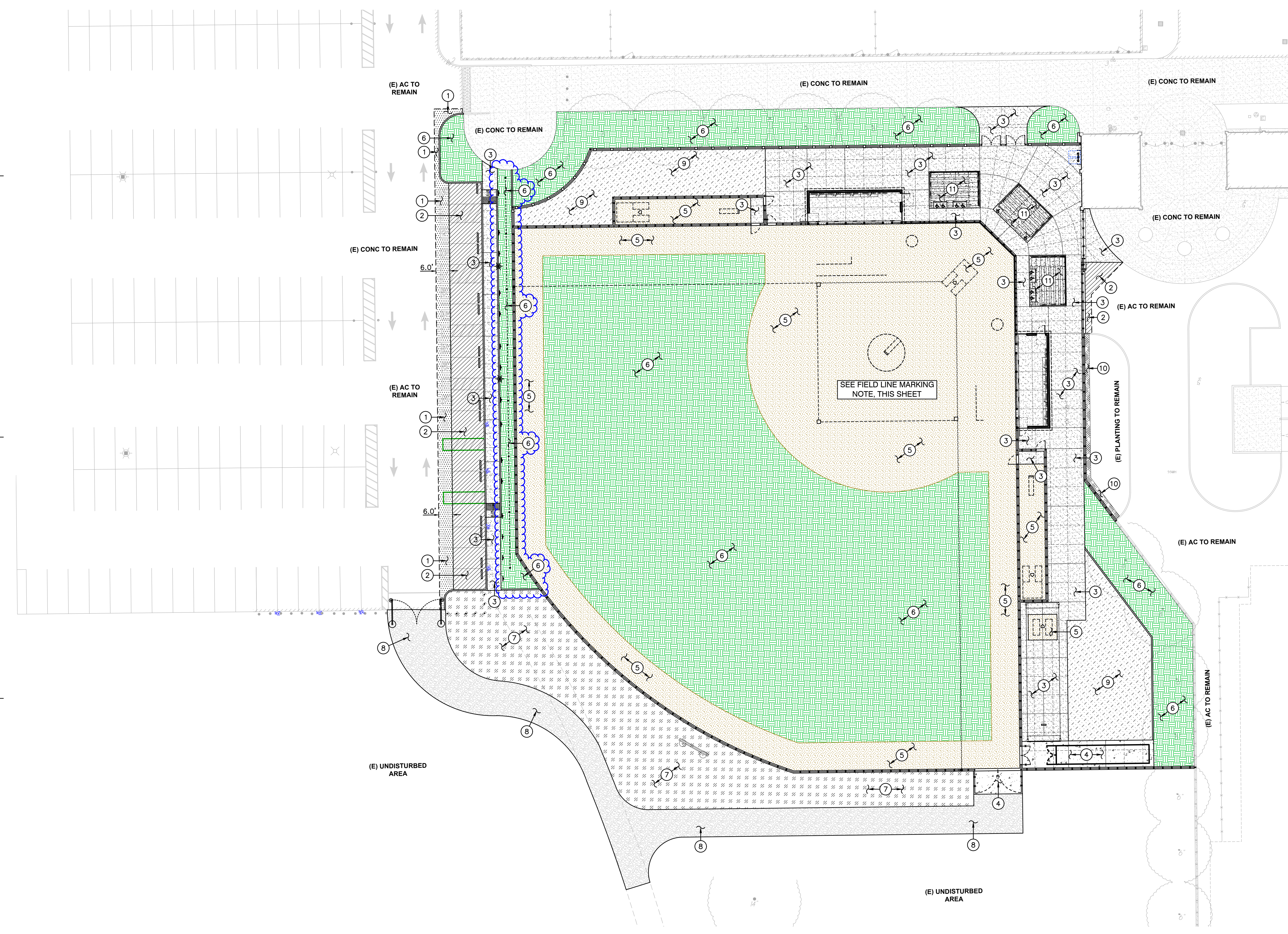

1 PAVING PLAN

SCALE 1" = 20'-0"



Delta	Date	Revisions	By



DSA BACKCHECK

This document is the property of the Owner and is not to be used without his written permission.

Client Project Number: Yuba Community College
2088 North Beale Road
Marysville, CA 95901

Project: **SOFTBALL FIELD**

Sheet Title: **PAVING PLAN**

Client Project Number: _____ Client Proj. _____

Scale: _____
 Drawn By: Author
 Checked By: Checker
 Issue Date: _____ Issue Date: _____
 Revit Version: 2023 Sheet of _____

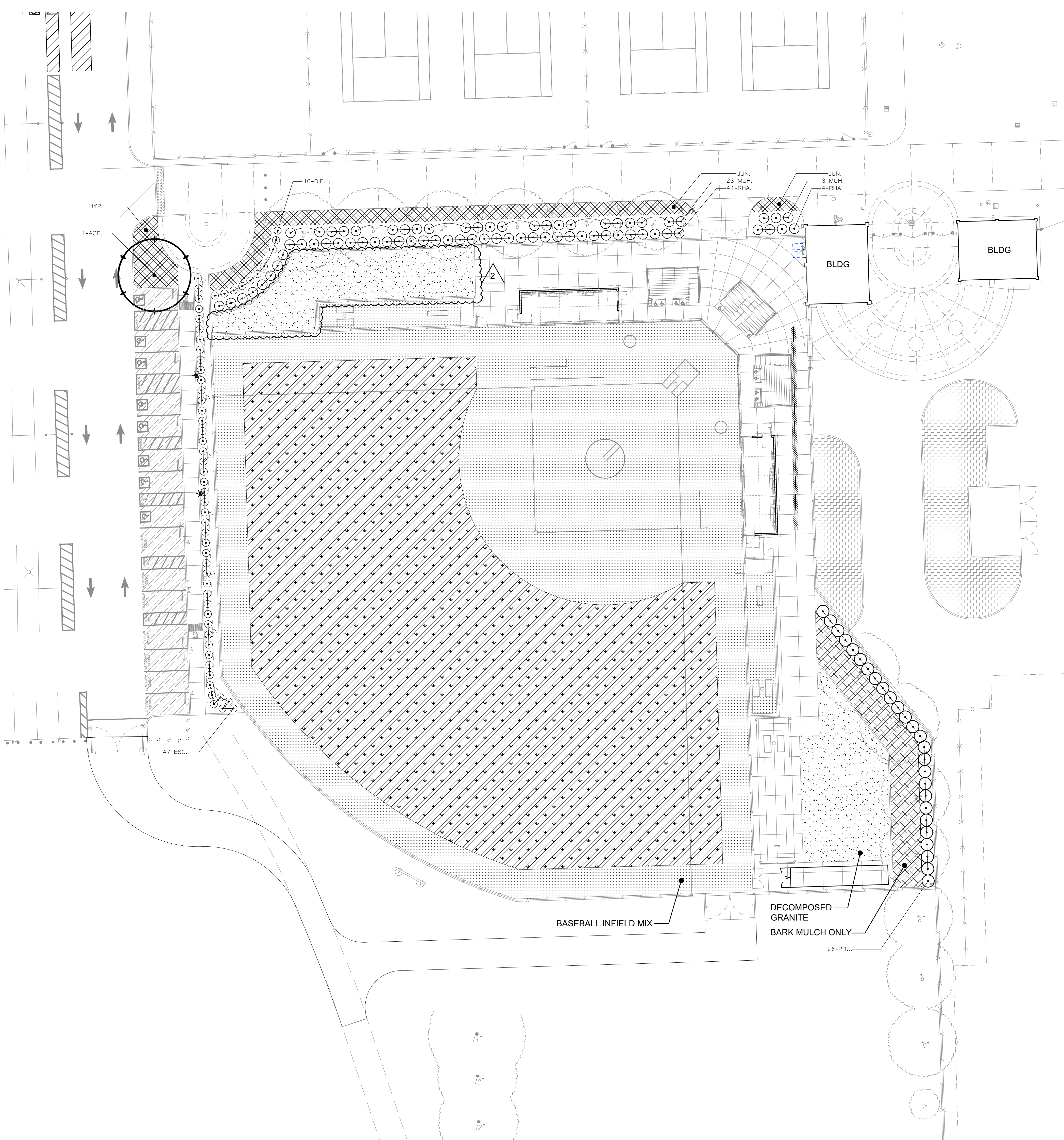

KEY

- TREE
- SHRUBS
- LAWN (SOD)
- GROUNDCOVER
- BARK MULCH ONLY
- BASEBALL INFIELD MIX
SEE CIVIL SHEETS
- DECOMPOSED GRANITE
SEE CIVIL SHEETS
- EXISTING LANDSCAPE AND SPRINKLER AREAS TO REMAIN
- PLANT QUANTITY
- PLANT KEY
- EXISTING TREES TO REMAIN

PLANT MATERIAL LIST

WATER USE	SIZE	QUANTITY	KEY	BOTANICAL NAME ... COMMON NAME
TREES:				
LOW	24" BOX	1	ACE	ACER RUBRUM 'OCTOBER GLORY' ... RED MAPLE
SHRUBS:				
LOW	5 G.C.	10	DIE	DIETES VEGETA ... FORTNIGHT LILY
LOW	5 G.C.	47	ESC	ESCALONIA RUBRA 'NEWPORT DWARF' ... DWARF ESCALLONIA
LOW	5 G.C.	26	MJH	MUHLENBERGIA CAPILLARIS ... PINK MUHLY
LOW	5 G.C.	26	PRU	PRUNUS CAROLINIANA 'BRIGHT N' TIGHT' ... CAROLINA LAUREL CHERRY
LOW	5 G.C.	45	RHA	RHAPHIOLEPS LIMBELLATA 'MINOR' ... YEWDA HAWTHORN
GROUNDCOVER:				
LOW	1 G.C.	24" O.C.	HYP	HYPERICUM CALYCIJUM ... CREEPING ST. JOHNSWORT
LOW	1 G.C.	36" O.C.	JUN	JUNIPERUS SABINA 'BUFFALO' ... JUNIPER

GENERAL LANDSCAPE REQUIREMENTS/NOTES

- NO PLANTING SHALL BE STARTED UNTIL SPRINKLER IRRIGATION SYSTEM HAS BEEN TESTED BY CONTRACTOR IN PRESENCE OF OWNER'S REPRESENTATIVE AND NOTED DEFICIENCIES CORRECTED.
 - NO PLANTING SHALL BE STARTED UNTIL SOIL PREPARATION AND FINISH GRADING OPERATIONS HAVE BEEN COMPLETED AND APPROVED BY THE OWNER'S REPRESENTATIVE.
 - QUANTITIES SHOWN ON PLANT MATERIAL LIST ARE APPROXIMATE. PROVIDE QUANTITIES INDICATED ON LANDSCAPE PLAN.
 - PLANT MATERIAL IS SUBJECT TO APPROVAL OF OWNER'S REPRESENTATIVE.
 - SEE SHEET L3.1 FOR PLANTING INSTALLATION DETAILS.
- ENVIRONMENTAL REQUIREMENTS:**
GENERAL: PROCEED WITH WORK IN ORDERLY AND TIMELY MANNER TO COMPLETE INSTALLATION OF LANDSCAPING WITHIN CONTRACT LIMITS.
- PROTECTION:**
EXISTING CONSTRUCTION: EXECUTE WORK IN AN ORDERLY AND CAREFUL MANNER TO PROTECT NEW CONCRETE WALKS, WORK OF OTHER TRADES, AND OTHER IMPROVEMENTS.
EXISTING UTILITIES: DETERMINE LOCATION OF UNDERGROUND UTILITIES AND PERFORM WORK IN A MANNER WHICH WILL AVOID POSSIBLE DAMAGE. HAND EXCAVATE, AS REQUIRED, TO MINIMIZE POSSIBILITY OF DAMAGE TO UNDERGROUND UTILITIES. MAINTAIN GRADE STAKES SET BY OTHERS UNTIL REMOVAL IS MUTUALLY AGREED UPON BY ALL PARTIES CONCERNED. BE RESPONSIBLE FOR PROTECTION OF EXISTING UTILITIES WITHIN CONSTRUCTION AREA; REPAIR DAMAGE TO UTILITIES THAT OCCUR AS A RESULT OF OPERATIONS OF THIS WORK.
LANDSCAPING: PROTECT LANDSCAPE WORK AND MATERIALS FROM DAMAGE DUE TO LANDSCAPE OPERATIONS, OPERATIONS BY OTHER CONTRACTORS AND TRADES AND TRESPASSERS. MAINTAIN PROTECTION DURING INSTALLATION AND MAINTENANCE PERIODS. TREAT, REPAIR OR REPLACE DAMAGED LANDSCAPE WORK AS DIRECTED AT NO ADDITIONAL COST TO CONTRACTOR.
- ADVERSE CONDITIONS:** WHEN CONDITIONS DETRIMENTAL TO SOIL OR PLANT GROWTH ARE ENCOUNTERED, SUCH AS RUBBLE FILL, ADVERSE DRAINAGE CONDITIONS, OR OBSTRUCTIONS, NOTIFY OWNER'S REPRESENTATIVE BEFORE STARTING WORK.

PLANTING AND TURF INSTALLATION SEASONS AND CONDITIONS
NO WORK SHALL BE DONE WHEN GROUND IS FROZEN, SNOW COVERED, TOO WET OR IN AN OTHERWISE UNSUITABLE CONDITION FOR AMENDING SOIL, FINISH GRADING OR PLANTING.

SOIL TESTING/SOIL IMPROVEMENT:
SEE SPECIFICATIONS 32 90 00, SECTION 3.02 SOIL TESTING AND SECTION 3.03 PREPARATION.

SOIL PERCOLATION
EXCAVATE 10 PLANTING PITS IN RANDOM AREAS OF SITE. FILL EXCAVATED PLANTING PITS WITH WATER TO 1/2 DEPTH OF PIT. PITS SHOULD DRAIN WITHIN 4 HOURS. IF PLANTING PITS DO NOT DRAIN, NOTIFY INSPECTOR IMMEDIATELY. PLANTING SHALL NOT BE STARTED UNTIL OWNER'S REPRESENTATIVE HAS RESOLVED A METHOD TO REMEDY DRAINAGE ISSUE.

PLANT MATERIAL STANDARDS
PLANTS SHALL BE IN ACCORDANCE WITH AMERICAN NATIONAL STANDARDS INSTITUTE (ANSI) ANSI Z60.1-AMERICAN STANDARD FOR NURSERY STOCK, EXCEPT AS OTHERWISE STATED IN SPECIFICATIONS OR SHOWN ON DRAWINGS. WHERE DRAWINGS OR SPECIFICATIONS ARE IN CONFLICT WITH ANSI Z60.1, DRAWINGS AND SPECIFICATIONS SHALL PREVAIL. PRUNE, THIN OUT AND SHAPE TREES IN ACCORDANCE WITH ANSI STANDARD HORTICULTURAL PRACTICE. PRUNE TREES TO RETAIN REQUIRED HEIGHT AND SPREAD, UNLESS OTHERWISE DIRECTED BY LANDSCAPE ARCHITECT. DO NOT CUT TREE LEADERS, AND REMOVE ONLY INJURED OR DEAD BRANCHES FROM FLOWERING TREES.

EXISTING LANDSCAPE AND SPRINKLER IRRIGATION SYSTEM
WORK LIMITS OF THIS PROJECT EXTEND INTO AREAS THAT WERE PREVIOUSLY DEVELOPED UNDER OTHER CONTRACTS. PRIOR TO START OF WORK, CONTRACTOR SHALL MEET WITH OWNER'S REPRESENTATIVE TO LOCATE ALL CONNECTIONS CALLED FOR ON DRAWINGS. WORK LIMITS/FENCING SHALL BE LAID OUT BY CONTRACTOR AND VERIFIED BY OWNER'S REPRESENTATIVE. FENCE TO BE INSTALLED AND IRRIGATION SYSTEM SHALL BE TESTED WITH CONTRACTOR, INSPECTOR, AND OWNER'S REPRESENTATIVE PRESENT. DEFICIENCIES SHALL BE NOTED AT THIS TIME AND ARE THE RESPONSIBILITY OF OWNER AT COMPLETION OF WORK. SYSTEM WILL AGAIN BE TESTED. DEFICIENCIES NOTED AT THIS TIME THAT WERE NOT NOTED PREVIOUSLY WILL BE RESPONSIBILITY OF CONTRACTOR. EXISTING LANDSCAPE THAT HAS BEEN DAMAGED DUE TO CONSTRUCTION SHALL BE RESTORED TO ORIGINAL CONDITION BY CONTRACTOR AT NO ADDITIONAL COST TO OWNER. PRIOR TO MAKING ANY CONNECTION TO MAIN LINE, CONTRACTOR SHALL NOTIFY OWNER 1 WEEK IN ADVANCE SO ADJUSTMENTS TO EXISTING WATERING PROGRAMS CAN BE MADE.



Revisions

Delta	Date	Revisions	By
2	7/13/23	Addendum #2	

CONSTRUCTION DOCUMENTS

23-34

2707 K Street, Suite 201
Sacramento, CA 95816
916.369.2990

Peter D. Larimer C-5284

This document is the property of the Owner and is not to be used without his written permission.

HY HIBSER YAMAUCHI Architects, Inc.

300 - 27th Street
Oakland, CA 94612
510.446.2222 tel | 510.446.2211 fax

HY Architects Project number: 5924
Facility
YUBA COMMUNITY COLLEGE
2088 NORTH BEALE ROAD
MARYSVILLE, CA 95901

Project
NEW SOFTBALL FIELD & SITE IMPROVEMENTS

Sheet Title
LANDSCAPE PLANTING PLAN

Client Project Number: Client Proj. #

Scale: Sheet

Drawn By: PL
Checked By: PL
Issue Date: 12/16/22
Revit Version: 2023

Sheet of
L1.1

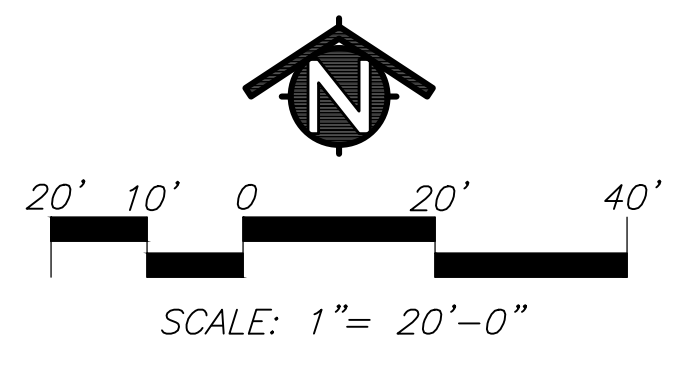

12/20/2022 4:01:02 PM C:\Revit_Local\5924\YCC Class & RR Reno\203_Initial\mapings@hyarch.com.vt

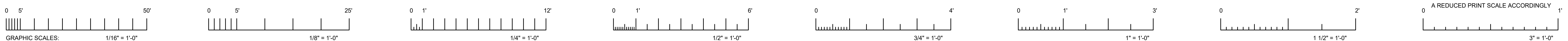

IF THIS SHEET IS NOT 30"x42", IT IS A REDUCED PRINT SCALE ACCORDINGLY

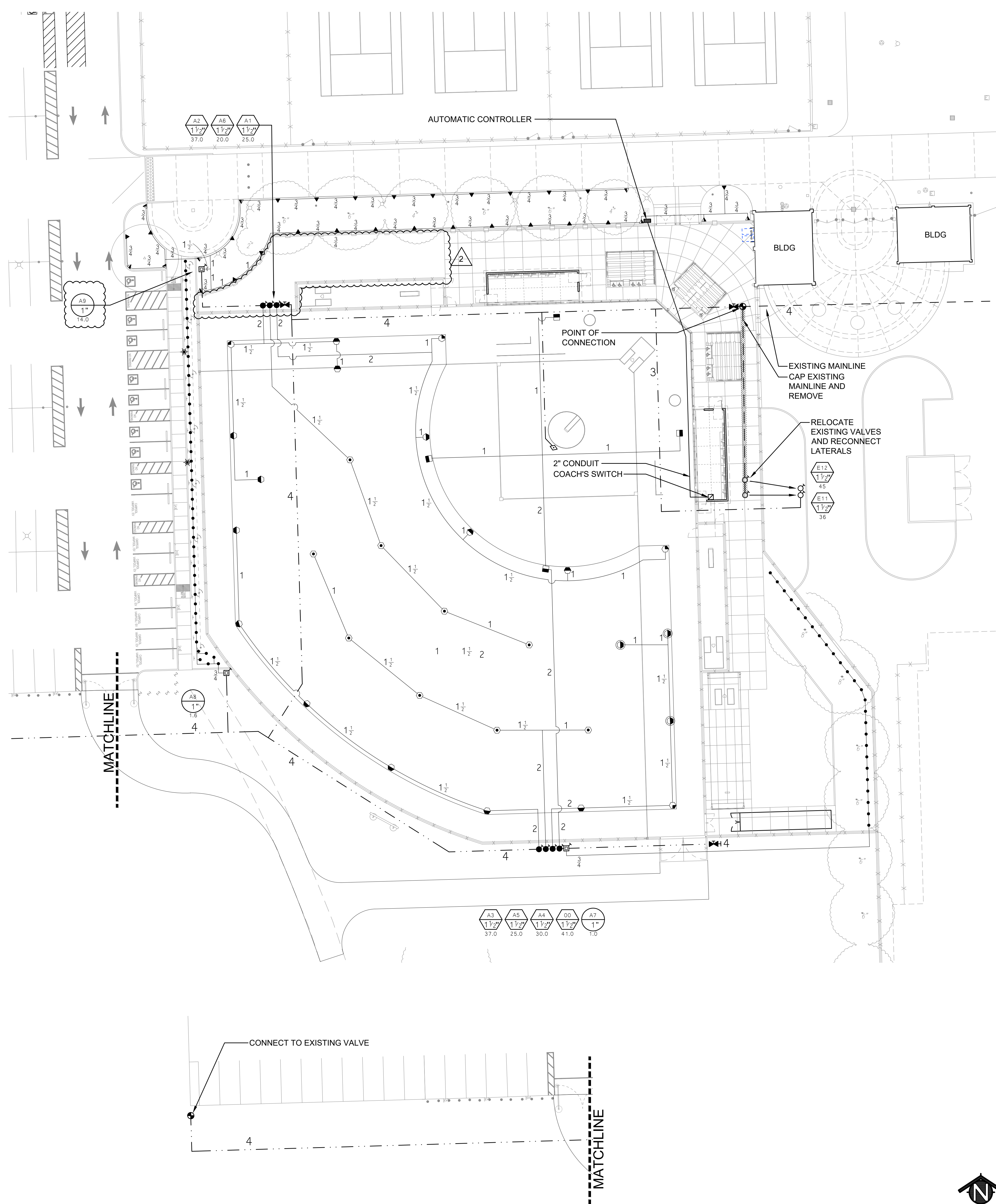

KEY

- SPRINKLER IRRIGATION LEGEND**
- AUTOMATIC CONTROLLER:**
RAINBIRD CENTRAL CONTROL SYSTEM;
RAINBIRD ESP-LXD IN STRONG BOX TOP ENTRY PEDESTAL
CONTRACTOR TO PROVIDE SCHOOL DISTRICT SOFTWARE LICENSE FOR RAINBIRD ICD
SURGE PROTECTOR FOR AUTOMATIC CONTROLLER - RAINBIRD LIGHTNING ARRESTOR
AND GROUNDING ROD/PLATE TO BE INSTALLED AS PER THE GROUNDING DETAIL.
COORDINATE 110V SERVICE AND POWER CONNECTION WITH ELECTRICAL SUB-CONTRACTOR.
COORDINATE ETHERNET CONNECTION WITH THE ELECTRICAL SUB-CONTRACTOR.
 - COACH'S SWITCH**
SITE ONE GREENTECH COACH'S SWITCH - WALL MOUNT
WIRE TO AUTOMATIC CONTROLLER
 - POINT OF CONNECTION:**
IRRIGATION SYSTEM OPERATING WATER PRESSURE: 80 PSI
MAXIMUM FLOW IS 41 GPM
CONTRACTOR SHALL LOCATE EXISTING 4" IRRIGATION MAINLINE
CONNECT AT THIS POINT AND EXTEND AS INDICATED ON DRAWINGS.
 - GATE VALVE:**
TYPE:
3" SIZE AND SMALLER: LEEMCO LGT-KXSS THREADED WITH A NON-RISING STEM AND HANDWHEEL.
4" SIZE AND LARGER: LEEMCO LMV-KXFF FLANGED WITH A NON-RISING STEM AND OPERATING NUT.
LEEMCO LMV-KXSS BELL WITH A NON-RISING STEM AND OPERATING NUT.
GATE VALVE INSTALLED IN A VALVE BOX WITH TOP OF BOX SET FLUSH TO FINISH GRADE.
GATE VALVE TO BE LINE SIZE.
 - PRESSURE MAIN LINE:**
TYPE:
3" SIZE AND SMALLER: ASTM D1785, PVC SCHEDULE 40.
4" SIZE AND LARGER: ASTM D1784 C900, DR 14, RUBBER GASKETED WITH LEEMCO FITTINGS
TRENCH DEPTH:
IN PLANTED AREAS:
POP-UP SPRAY HEADS - 12" MINIMUM COVER.
ROTOR HEADS - 18" MINIMUM COVER.
BUBBLER HEADS - 12" MINIMUM COVER.
UNDER PAVED AREAS: 24" MINIMUM COVER.
PVC SCHEDULE 40 SLEEVES ARE REQUIRED FOR ALL PIPING UNDER PAVEMENT.
 - LATERAL LINE:**
TYPE:
ASTM D1785, PVC SCHEDULE 40, SOLVENT WELD ALL UNSIZED PIPE SHALL BE 3/4" SIZE.
TRENCH DEPTH:
IN PLANTED AREAS:
POP-UP SPRAY HEADS - 12" MINIMUM COVER.
ROTOR HEADS - 18" MINIMUM COVER.
BUBBLER HEADS - 12" MINIMUM COVER.
UNDER PAVED AREAS: 24" MINIMUM COVER.
PVC SCHEDULE 40 SLEEVES ARE REQUIRED FOR ALL PIPING UNDER PAVEMENT.
 - AUTOMATIC CONTROL VALVE:**
RAINBIRD PRESS-PRS-D SERIES WITH RAINBIRD FD-10TURF SINGLE STATION DECODER
VALVE SHALL HAVE PRESSURE REGULATION OPTION.
 - QUICK COUPLER VALVE:**
RAINBIRD 44NP
VALVES SHALL HAVE LOCKING RUBBER COVERS, INSTALLED IN VALVE BOXES. TOP OF
VALVE BOX SHALL HAVE BOLT DOWN LID AND TOP SET LEVEL TO FINISH GRADE.
 - LAWN POP-UP ROTOR HEADS:**
FULL CIRCLE
RAINBIRD: 5006-FC-SAME-SS-4.0 (65 PSI)
HALF CIRCLE
RAINBIRD: 5006-PC-SAM-SS-6.0 (65 PSI), 5006-PC-SAM-SS-4.0 (65 PSI)
QUARTER CIRCLE
RAINBIRD: 5006-PC-SAM-SS-4.0 (65 PSI)
 - INFIELD POP-UP ROTOR HEADS:**
HALF CIRCLE
RAINBIRD: 8005-SS-10 (60 PSI)
 - AUTOMATIC DRIP IRRIGATION VALVE/FILTER/PRESSURE REGULATOR:**
RAINBIRD CONTROL ZONE KIT MODEL XC2-100-PRB-COM
WITH RAINBIRD FD-10TURF SINGLE STATION DECODER
 - SHRUB BUBBLER:**
HUNTER HEB-20 EMITTER WITH SCREEN CV.
 - SHRUB POP-UP SPRAY HEADS:**
RAINBIRD: RD06-S-P45 BODY WITH HUNTER MP800SR SERIES NOZZLES. (45 PSI REGULATION)
TORO: ST02-EP-PROOM SERIES WITH TORO PRECISION SERIES NOZZLES. (ONLY PROVIDES 30 PSI REGULATION)
HUNTER: PROS-06-PRS40-CV WITH HUNTER MP800SR SERIES NOZZLES. (40 PSI REGULATION)
FULL, HALF, AND QUARTER SPRAY PATTERNS.
 - INDICATES CONTROL VALVE AND STATION NUMBER**
 - INDICATES CONTROL VALVE SIZE**
 - INDICATES GALLONS PER MINUTE**
 - EXISTING TREE PROTECTION AREA:**
THE PROTECTION AREA UNDER ANY EXISTING TREE THAT IS TO REMAIN IS DEFINED BY ITS DRIP LINE OR
CANOPY COVER. WITHIN THIS AREA NO STORAGE OR PARKING WILL BE PERMITTED. ALL TRENCHING WILL BE
PERFORMED BY HAND. DO NOT CUT ROOTS 1" IN DIAMETER OR LARGER. USE BORING PROCEDURES WHEN
ENCOUNTERING ROOTS 1" SIZE AND LARGER. NO ROOTS ARE TO BE EXPOSED LONGER THAN 48 HOURS.

SPRINKLER IRRIGATION NOTES

1. COMPOSITE BASE SHEET: PROPOSED IMPROVEMENTS SHOWN ON DRAWINGS ARE SUPERIMPOSED ON A COMPOSITE BASE SHEET. THE COMPOSITE BASE SHEET IS A COMPILATION OF ARCHITECTURAL, ENGINEERING, AND OTHER DATA THAT IS PROVIDED. THE LANDSCAPE ARCHITECT SHALL NOT BE HELD LIABLE FOR CHANGES, INACCURACIES, OMISSIONS, OR ERRORS PERTAINING TO THE COMPOSITE BASE SHEET. CONTRACTOR SHALL BE RESPONSIBLE FOR REVIEWING THESE DOCUMENTS. ANY DISCREPANCIES NEED TO BE BROUGHT TO THE ATTENTION OF THE DESIGN TEAM AND RESOLVED PRIOR TO CONTINUATION OF WORK.
2. DESIGN PRESSURE SHOWN ON PLANS HAS BEEN FURNISHED BY WATER COMPANY OR WATER DISTRICT SERVING SITE. VERIFY PRESSURE ON-SITE PRIOR TO THE INSTALLATION OF ANY SPRINKLER IRRIGATION EQUIPMENT. IF THERE IS A DISCREPANCY, NOTIFY OWNER'S REPRESENTATIVE IMMEDIATELY IN WRITING SO ADJUSTMENTS CAN BE MADE BY LANDSCAPE ARCHITECT. FAILURE TO REPORT DISCREPANCIES AND CONTINUANCE OF WORK WILL RESULT IN ALL RE-DESIGN COSTS BEING CHARGED TO CONTRACTOR.
3. DETERMINE LOCATION OF UNDERGROUND UTILITIES. DAMAGE CAUSED BY INSTALLATION OF THIS WORK SHALL BE REPAIRED TO SATISFACTION OF GOVERNING AGENCY OR OWNER AT NO ADDITIONAL COST TO THE CONTRACT.
4. SPRINKLER OVER SPRAY SHALL NOT BE ALLOWED ON PUBLIC SIDEWALKS, BUILDING WALLS OR FENCES. MINIMUM OVERSPRAY MAY OCCUR IN PARKING AREAS. USE ADJUSTABLE NOZZLES WHENEVER POSSIBLE TO CONTROL SPRINKLER OVERSPRAY.
5. ALL LOCAL CODES AND ORDINANCES SHALL BE COMPLIED WITH. IF THERE IS A CONFLICT, NOTIFY OWNER'S REPRESENTATIVE IMMEDIATELY.
6. TESTING:
A. PRESSURE TEST ALL UNDERGROUND PIPING AS FOLLOWS:
MAIN LINE - AT 100 PSI FOR 4 HOURS.
LATERAL LINES - AT 100 PSI FOR 2 HOURS.
B. COVERAGE TEST: NOTE: PRIOR TO REQUESTING COVERAGE TEST, INSURE ALL HEADS ARE SET PLUMB, NOZZLES ARE ADJUSTED PROPERLY AND SYSTEM HAS BEEN CHECKED FOR AUTOMATION. REQUEST OWNER'S REPRESENTATIVE'S PRESENCE ON-SITE WHEN SPRINKLER SYSTEM IS COMPLETELY INSTALLED AND FULLY AUTOMATIC. PROVIDE ADEQUATE PERSONNEL AT THIS MEETING TO ADJUST AND FINE TUNE SYSTEM TO SATISFACTION OF OWNER'S REPRESENTATIVE.
7. LAYOUT ALL WORK PRIOR TO TRENCHING OPERATIONS TO DETERMINE IF MINOR MODIFICATIONS OR ADJUSTMENTS WILL BE REQUIRED.
8. INSTALL ALL SPRINKLER HEADS PERPENDICULAR TO SLOPES OR GRADE.
9. CONTROL WIRE SHALL BE UF-14, COLOR FOR LEAD AND WHITE FOR COMMON. SPLICES SHALL BE PERMITTED AT VALVE BOX LOCATIONS ONLY.
10. PROVIDE AND INSTALL AUTOMATIC CONTROLLER AND UF-14 CONTROL WIRE. ELECTRICAL SUBCONTRACTOR SHALL PROVIDE 110V SERVICE AND SERVICE HOOKUP FROM POWER SOURCE TO AUTOMATIC CONTROLLER.
11. COORDINATE ALL WORK WITH OTHER TRADES SO PROGRESS OF WORK IS NOT INTERRUPTED AND CAN BE COMPLETED IN A TIMELY MANNER.
12. NO PLANTING SHALL BE STARTED UNTIL ALL SPRINKLER WORK HAS BEEN TESTED AND APPROVED IN PRESENCE OF OWNER'S REPRESENTATIVE.
13. FOR SPRINKLER IRRIGATION INSTALLATION DETAILS, SEE SHEET NO. L3.2 AND L3.3.



Revisions			
Delta	Date	Revisions	By
2	7/13/23	Addendum #2	

CONSTRUCTION DOCUMENTS

23-34

MTW group
LANDSCAPE ARCHITECTURE AND PLANNING
2707 K Street, Suite 201
Sacramento, CA 95816
916 369-2990

Peter D. Larimer C-5284

This document is the property of the Owner and is not to be used without his written permission

HY HIBSER YAMAUCHI Architects, Inc.
300 - 27th Street
Oakland, CA 94612
510.446.2222 tel; 510.446.2211 fax

HY Architects Project number: 5924
Facility
YUBA COMMUNITY COLLEGE
2088 NORTH BEALE ROAD
MARYSVILLE, CA 95901

Project
NEW SOFTBALL FIELD & SITE IMPROVEMENTS

Sheet Title
LANDSCAPE IRRIGATION PLAN

Client Project Number: _____ Client Proj. # _____
Scale: _____ Sheet _____
Drawn By: PL
Checked By: PL
Issue Date: 12/16/22
Revit Version: 2023
L2.1
Sheet of _____

C:\Revit_Local\5524\YCC Class & RR Reno\203_Jellema\magp@hyarch.com.rvt 12/22/2022 4:01:02 PM

